







# Bytová jednotka 1.7

-  návrh interiéru
-  el. interiérové rolety

- Praha centrum  20 min
- Letiště  15 min
- Supermarket  5 min
- Doprava BUS  2 min
- MŠ, ZŠ  2 min

podlaží: 1.NP  
dispozice: 3+kk  
orientace: JV  
celková užitná plocha: 49,1 m<sup>2</sup>  
**celková podlahová plocha: 52,2 m<sup>2</sup>**

01	zádveří	2,6 m <sup>2</sup>
02	koupelna	2,9 m <sup>2</sup>
03	wc	1,5 m <sup>2</sup>
04	obývací pokoj + kuchyň	21,2 m <sup>2</sup>
05	ložnice	11,0 m <sup>2</sup>
06	pokoj	9,9 m <sup>2</sup>

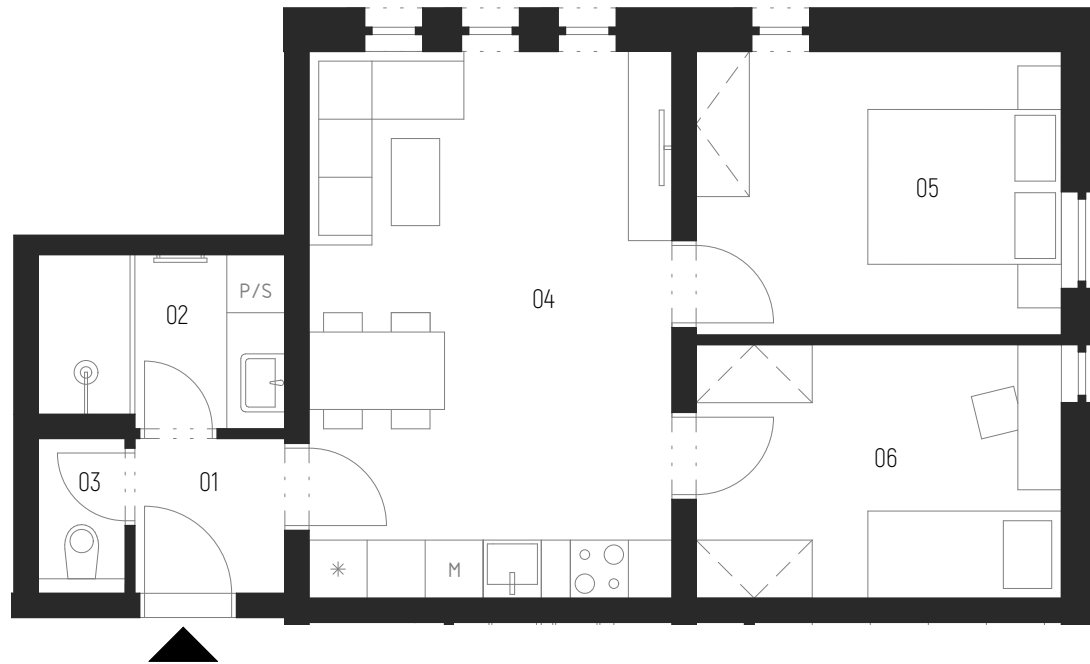

kontaktní údaje:

773 080 333  
prodej@jakesdevelopment.cz  
www.jakesdevelopment.cz



BYT 1.7