







Bytová jednotka 3.2

-  návrh interiéru
-  el. interiérové rolety

podlaží: 3.NP
dispozice: 1+kk
orientace: SV
celková užitná plocha: 46,9 m²
celková podlahová plocha: 49,7 m²

3.NP
1+kk
SV
46,9 m²
49,7 m²

01	zádveří	3,8 m ²
02	koupelna s wc	3,9 m ²
03	obytná ložnice + kuchyň	34,5 m ²
04	terasa	4,7 m ²

- Praha centrum  20 min
- Letiště  15 min
- Supermarket  5 min
- Doprava BUS  2 min
- MŠ, ZŠ  2 min

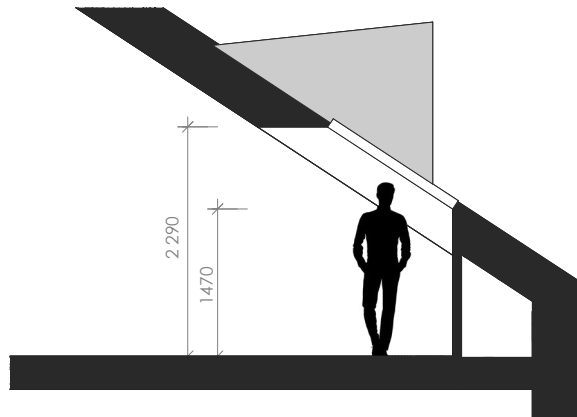
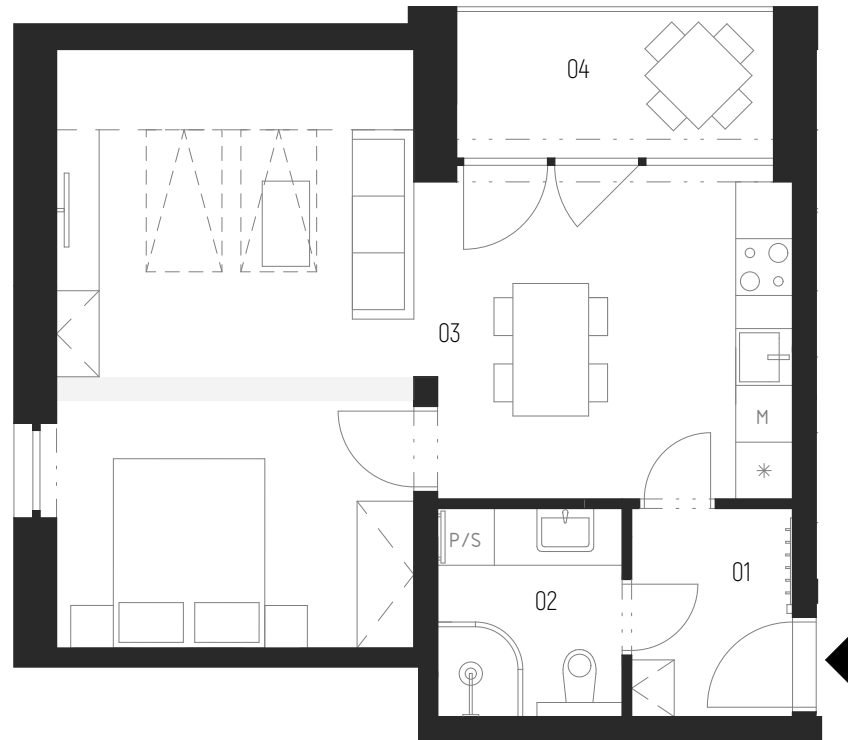

kontaktní údaje:

608 301 842
d.andrle@jakesdevelopment.cz
www.jakesdevelopment.cz

BYT 3.2

