







Bytová jednotka 1.7

-  návrh interiéru
-  el. interiérové rolety

- Praha centrum  20 min
- Letiště  15 min
- Supermarket  5 min
- Doprava BUS  2 min
- MŠ, ZŠ  2 min

podlaží: 1.NP
dispozice: 3+kk
orientace: JV
celková užitná plocha: 49,1 m²
celková podlahová plocha: 52,2 m²

01	zádveří	2,6 m ²
02	koupelna	2,9 m ²
03	wc	1,5 m ²
04	obývací pokoj + kuchyň	21,2 m ²
05	ložnice	11,0 m ²
06	pokoj	9,9 m ²

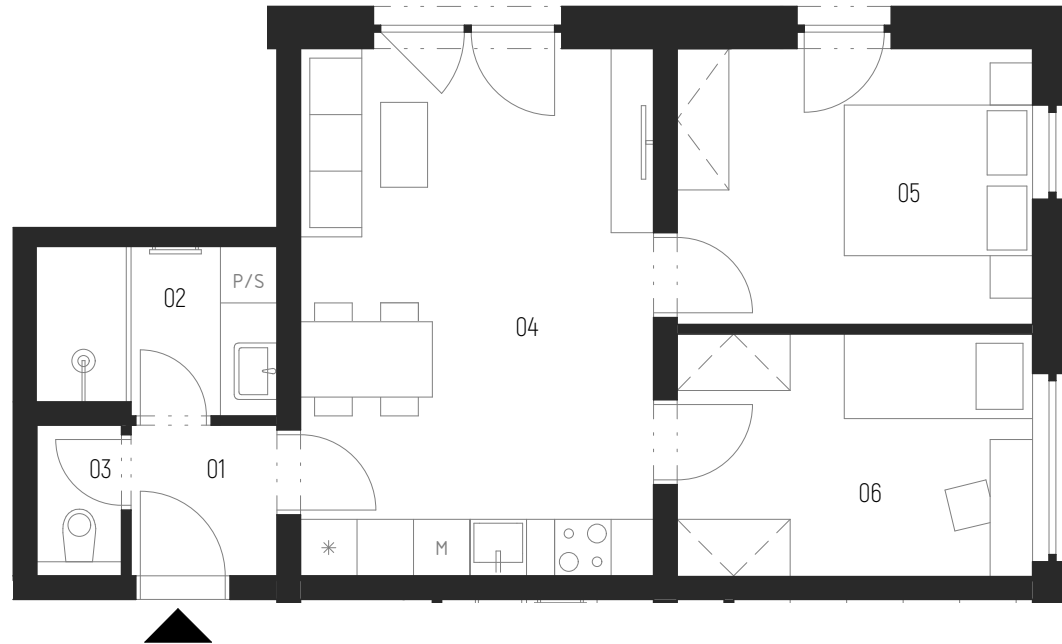

kontaktní údaje:

773 080 333
prodej@jakesdevelopment.cz
www.jakesdevelopment.cz



BYT 1.7

